

Option 3: Playground Inspired by Edwardian Floral Wallpaper

This design is inspired by the floral patterns of Edwardian wallpaper. The layout uses curved, sharp edges and petal-like shapes to create pathways, seating areas, and play zones, creating a playground that celebrates both nature and Edwardian art.

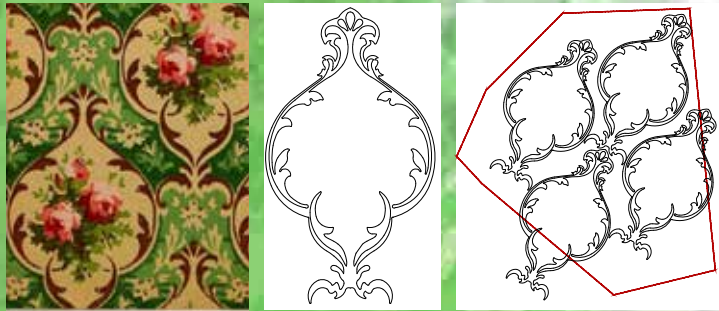

1 Proposed Play Equipment - Bespoke Timber bridge on the play mound

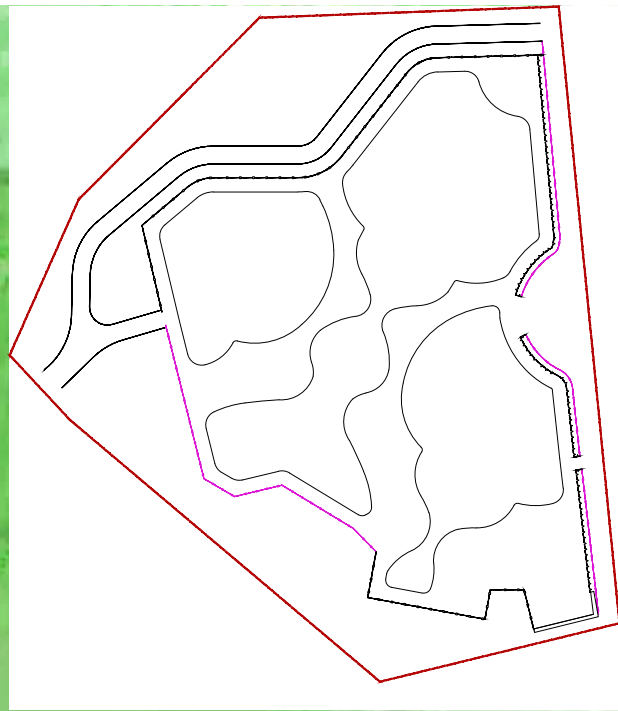

2 Proposed Play Equipment - Multispinner Carousel, Teal



3 Proposed Play Equipment - Play Panel High 2 - Music



4 Proposed Play Equipment - Sensory Multi Play Panel



5 Proposed Play Equipment - Play Panel 1 - Maze



6 Proposed Play Equipment - Ice Cream Cart



7 Proposed Play Equipment - Steel Swing H:2.5m, 100cm Rope Seat, Anti-wrap



8 Proposed Play - Toddler Equipment -Creative Workshop



9 Proposed Play Equipment - Wheelchair Carousel



10 Proposed Play Equipment - Blazer



11 Proposed Play Equipment - Play & Learn Blackboard



12 Existing Play Equipment - Balance Posts with Rope



13 Proposed Play Equipment - Explorer Dome



18 Proposed Play - Inclusive Twister



27 Proposed Play Equipment - New Porous Wetpour Rubber Granules Playground Safety Surface



28 Proposed Tree Pit / Surfacing Close to Tree - New Porous Rubber Mulch



15 Proposed Play - Bespoke Tunnel Through Mound with climbing grips



16 Proposed Play Equipment - Hangout Tree with Hideaway



17 Proposed Play Equipment - Hexagonal Jumping Net



18 Proposed Play Equipment -Bespoke Play Mound with climbing grips



19 Proposed Play Equipment - CocoWave Pendulum Swing on the sand base



20 Proposed Play Equipment - Climbing Structure - BLOXX 1



21 Proposed Play Equipment - Vertical Net / Wall



22 Proposed Furniture - Stair Benches - Bespoke



23 Proposed Green Buffer - Shrub Mix



24 Proposed Green Buffer - Climbers Planting on Trellis



25 Proposed Shade - Cantilever Umbrella - Vary Size



26 Proposed New Path- Permeable Resin Bound Gravel