

This map is reproduced from Ordnance Survey material with the permission of the Controller of Her Majesty's Stationery Office © Crown copyright. Unauthorised reproduction infringes Crown copyright and may lead to prosecution or civil proceedings 1,000-19441 [2016].

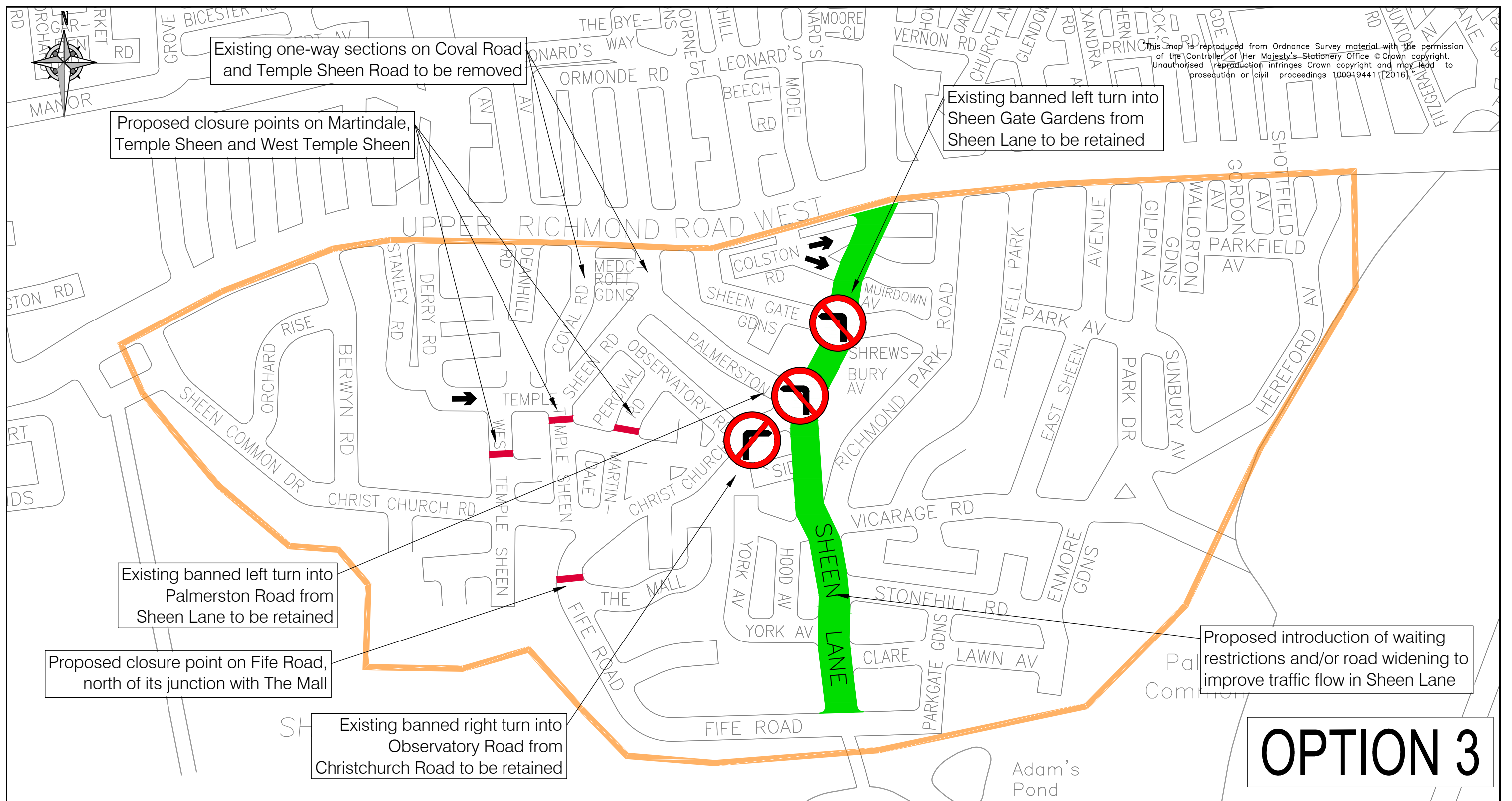

OPTION 3

Legend:

- Extents of proposed Controlled Parking Zone
- Proposed waiting restrictions and / or carriageway widening
- Proposed closure point

REVISION	AMENDMENT	AJ 10/07/19 DRAWN BY AND DATE	RP 10/07/19 DESIGNED BY AND DATE	RP 25/07/19 CHECKED BY AND DATE	RP 25/07/19 APPROVED BY AND DATE
			DRAFT	SCALE (AT A3 SIZE)	
			ISSUE	NTS	
CLIENT		LONDON BOROUGH OF RICHMOND UPON THAMES			
PROJECT		EAST SHEEN LOW TRAFFIC NEIGHBOURHOOD			
DRAWING TITLE		PROPOSED PACKAGE OF MEASURES OPTION 3			
ISSUING OFFICE	TWICKENHAM	DRAWING NUMBER		REVISION	
TELEPHONE	020 88911411	1049-CS-GA-ESHN-03		-	