

CONSULTATION DETAILS:

Tell us what you think on the website by the
the
[https://haveyoursay.citizenspace.com/
richmondce/castelnauparade-23](https://haveyoursay.citizenspace.com/richmondce/castelnauparade-23)

GET IN TOUCH:

Email: consultation@richmond.gov.uk

This is the scheme that will be delivered on site, subject to funds being secured by the Local Authority.



PROJECT
CENTRE



CASTELNAU

'Tell us what you think about our proposals to transform part of the parade'

Castelnau Parade has been negatively impacted by the Hammersmith Bridge closure.

The aim of this initiative is to create improvement to the public space, enhance the community's experience and encourage people to spend more time here.

The bigger picture is to encourage businesses to move into the area.

The Parade can also be a hub for wider links – to Barnes Village, to the river towpath and become part of the wider art trails. All of which would encourage visitors to the Parade.

PROJECT
CENTRE

Proposed scheme

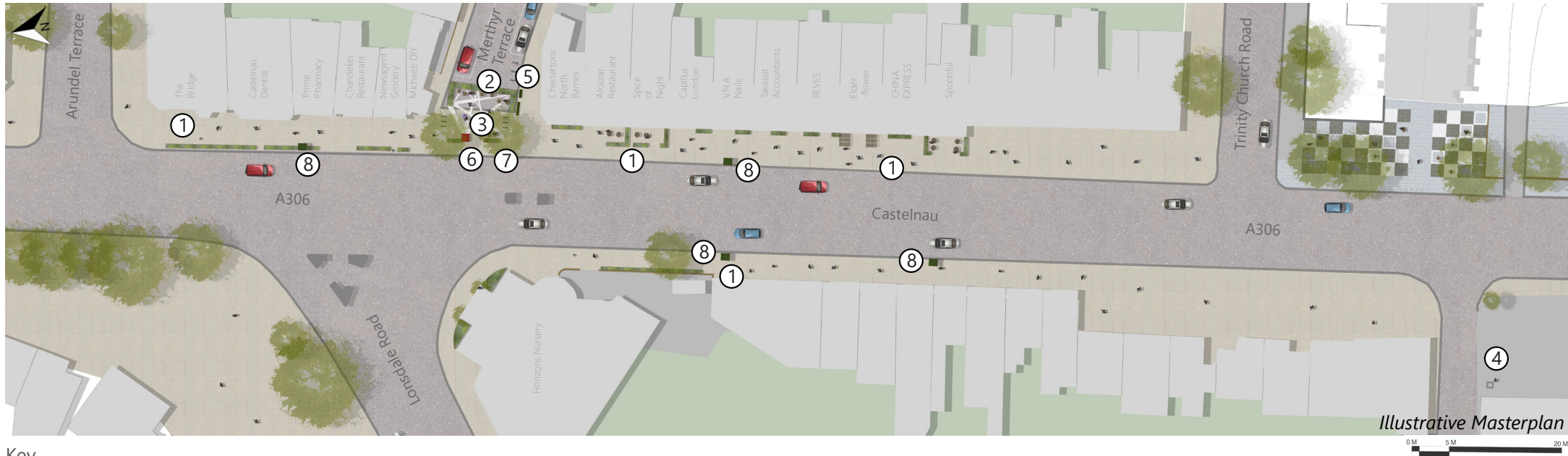

Key

- ① Planters**
Planters will bring a green edge to Castelnau and incorporate lavender to reflect the historic planting in the area.
- ② Pocket Park**
Create a flexible green pocket park that can be used by the community, with seating and greening. A series of events could be hosted here throughout the year, e.g. Christmas Markets.
- ③ Relocated Phone Box**
Look to relocate the phone box, or add pop up coffee or box office- perhaps within the Pocket Park, and utilise it as a community asset subject to permissions.
- ④ EV Charging Spot**
Investigate if Tesco can host an EV charging unit or Trinity Church Road.
- ⑤ Mural**
Use the blank end of the building to create art work that celebrates Castlenau, subject to permissions. It could become the beginning of a new art trail in Barnes.
- ⑥ Signage**
Review a wayfinding strategy - one down by the river / pedestrian link to let people know Castelnau is nearby and has coffee.
- ⑦ Cycle Infrastructure / Street furniture**
Create a suite of accessible street furniture that is functional and in-keeping with the conservation area setting. More cycle infrastructure is proposed to encourage active travel.
- ⑧ New External Bin**
New external bin for residential waste.

Pocket Park

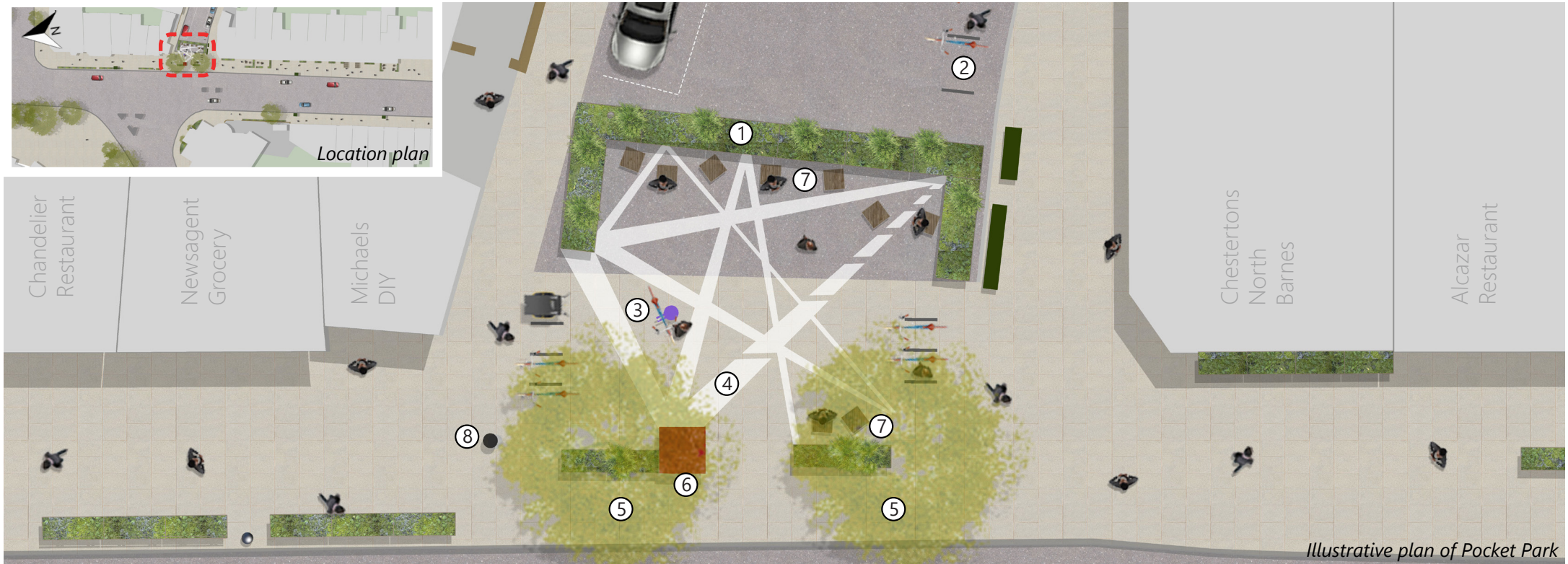

Illustrative plan of Pocket Park

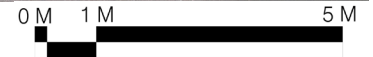

Key

- ① Free standing planters
- ② Additional cycle parking
- ③ Cycle repair station
- ④ Informal play thermo plastic markings or paving pattern
- ⑤ Feature lighting in trees
- ⑥ Relocated, repurposed phone box
- ⑦ Seating cubes
- ⑧ Add signage to existing infrastructure





Daytime



Night time

Artistic impression of Pocket Park

Green Edge / Green Screen

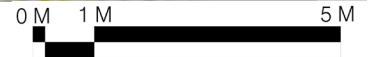
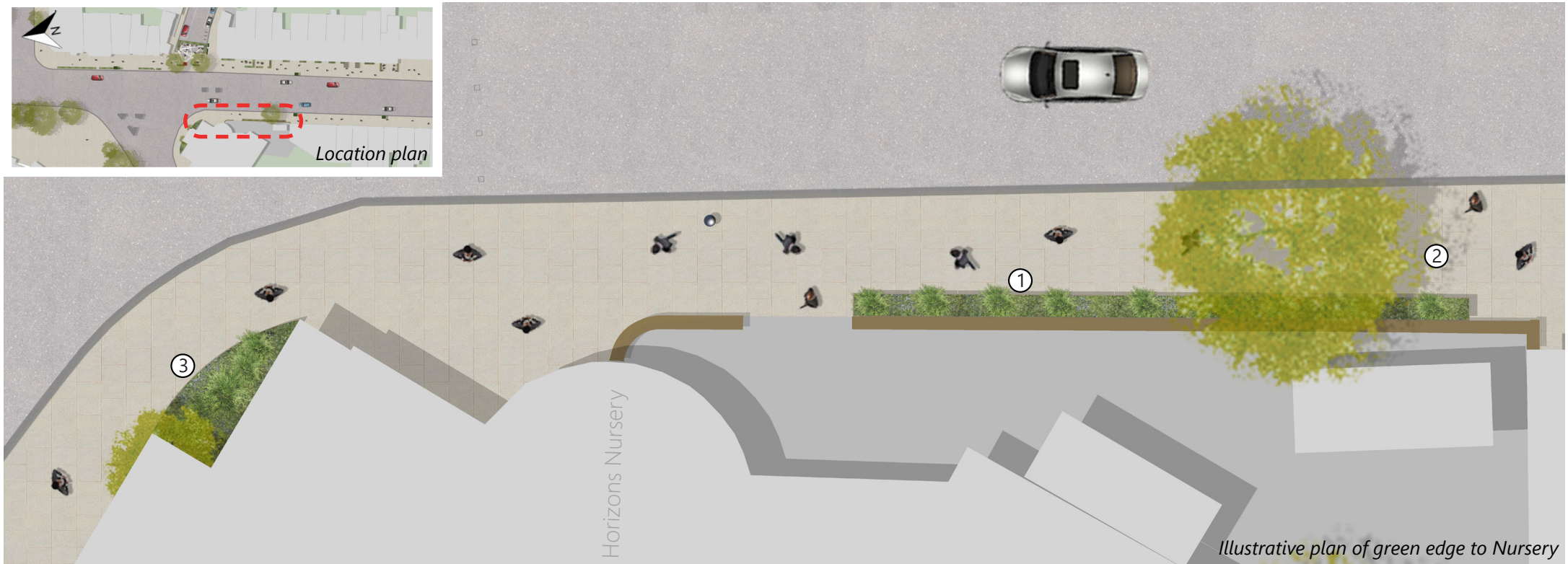

Key

- ① Free standing planters with 1.2m high ivy screen
- ② Decluttering of redundant signage
- ③ Bespoke curve planters to front of nursery
- ④ Existing external bin

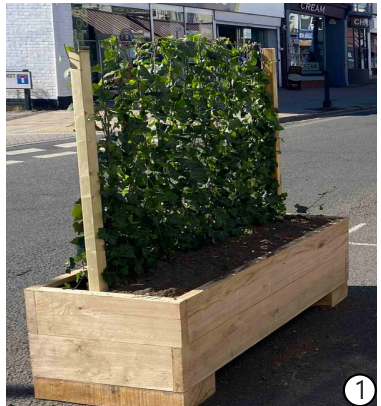

Planters on the Parade

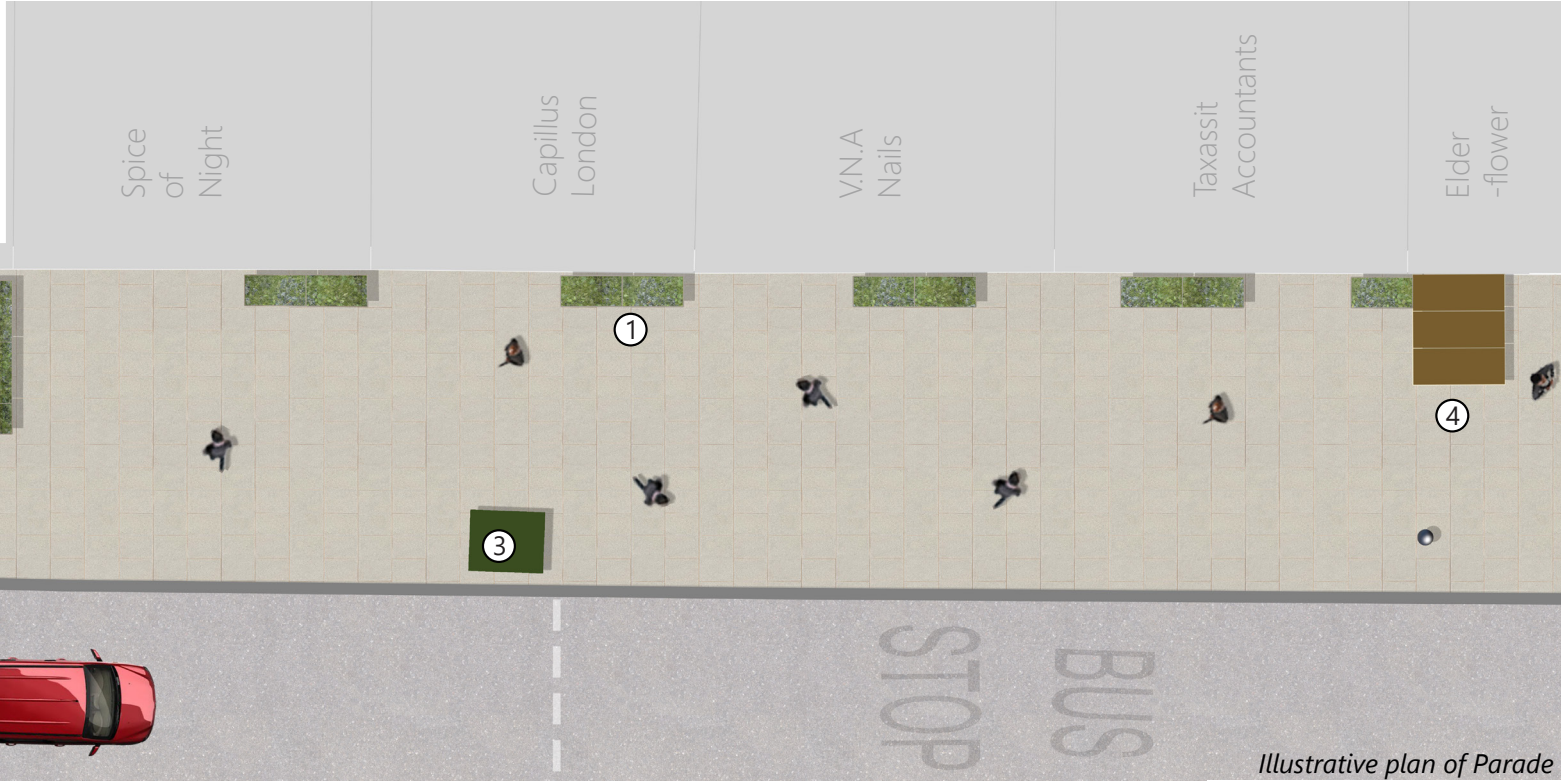
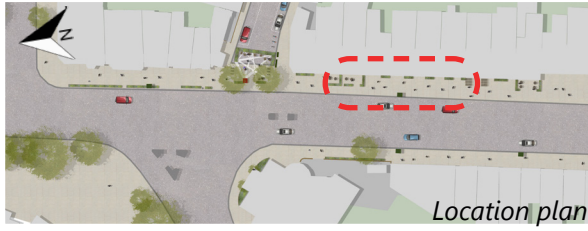

Key

- ① Free standing planters
- ② Businesses spill out spaces with tables and chair
- ③ Relocated existing external bin
- ④ Existing shop display furniture

